

Wilier TRIESTINA®

RAVE^{SL}

TECHNICAL INTRODUCTION
REV.01

RAVE_{SL}

The Rave SL is our second step towards a new horizon. An origin shared with the Rave SLR project. Race geometries come together in a single bike endowed with two souls: road and gravel. We have kept our vision intact. We have let every thought, every consideration flow. We have concentrated on the technical details with just one target in mind: putting the focus on cyclists who love to ride on any terrain with just one bike, without taking themselves too seriously.

The geometries and the design stem from the SLR platform and combine with a new material. The carbon fibre frame features a different lamination solution where the ingredient may change but not the form. Considering the same frame size, the Rave SL weighs just 140 g more than the highly decorated Rave SLR.

Scalable technology combined with the skillful crafting of the carbon fibre reproduces Wilier's SL philosophy, becoming the common denominator between the Rave SL, the Filante SL and the O SL.



2

WILIERPEDIA 2024

GRAVEL COLLECTION

RAVE^{SL}

FROM DIRT ROAD TO ASPHALT: READY FOR EVERY ADVENTURE

The Rave SL is an all-purpose bike that does not shy away from competing. Road or gravel, it doesn't matter. The tyre clearances make it possible to fit tyres with a max section of 42 mm (700x42c).



TWO SOULS IN EVERY COLOUR

The Rave SL echoes the racing geometries of its big sister, the SLR. Six available frame sizes: XS, S, M, L, XL, XXL. The two available colours have been conceived to reflect both the road and gravel setups, with sandy tones reminiscent of off-road riding.



SMART INTEGRATION

No visible cables. The aluminium alloy vertical tube and aero handlebar fully maintain the flair of the Rave product range. A technical choice that makes it possible to contain the price without compromising the performance and the possibility to easily personalise the setup.



SL PHILOSOPHY

In addition to expanding the product range, the intention of each SL series bike is to provide the best quality/price/performance ratio. The use of technologies and setups that are less extreme aims to preserve the overall quality of each product. Did we succeed? You be the judge.



RAVE_{SL}

COLOR	BLACK, SILVER
FINISH	GLOSSY
COLOR CODE	V5



COLOR	BROWN, SAND
FINISH	GLOSSY
COLOR CODE	V6





GEOMETRIES AND SIZES

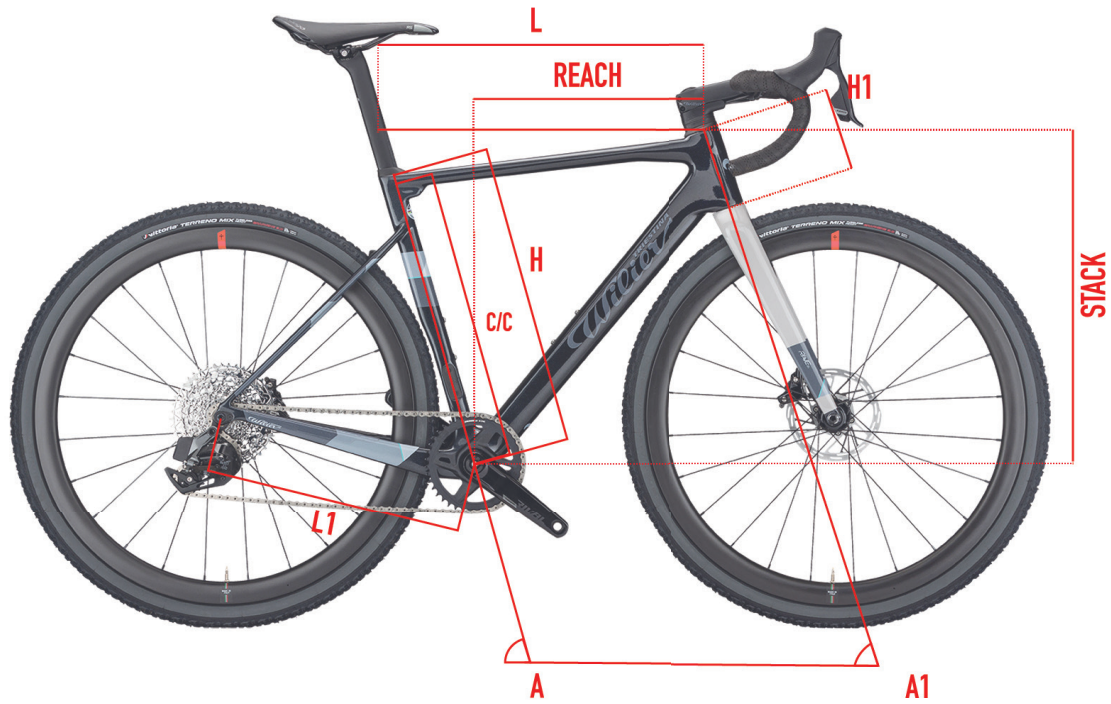

	REACH	STACK	H	C/C	L	A	H1	L1	A1	WHEELBASE
SIZE	[mm]	[mm]	[cm]	[cm]	[cm]	[°]	[cm]	[cm]	[°]	[mm]
XS	370	513	45	43.2	51	75	9.8	42.1	70	997
S	377	532	48	46.2	52.7	74.5	11.8	42.2	70	1012
M	384	551	50	48.2	54.5	74	13.4	42.3	71	1017
L	391	570	52	50.2	56.1	73.5	15.4	42.3	71	1031
XL	398	589	54	52.2	57.9	73	17.2	42.5	71.5	1041
XXL	405	608	56	54.2	59.7	72.5	18.9	42.7	72	1051





KEYPOINTS



FRAME AND TECHNICAL SPECS DETAILS	
HEADTUBE	1" 1/4 - 1" 1/4
UPPER BEARING	WTP-BEARING-SSLIM 39X46.9X7
LOWER BEARING	FSA MR137 37X46.9X7
FRONT FORK O.L.D.	100mm
REAR STAYS O.L.D.	142mm
BB SHELL	SHIMANO PRESS FIT (86.5 WIDE X 41 diameter)
SEAT POST	WILIER SEATPOST 0/-15
FRONT DERAILEUR	REMOVABLE FRONT DERAILEUR SUPPORT
SEAT POST COLLAR	WTP-SPEXP

FAQ

How much does the frame weigh?

The frame weighs 1090 g for a painted size M.

What transmissions can be installed on the Rave SL?

Rave SL is intended for competition gravel. This is why it can mount groups designed for use on both gravel and road as well. The bike can be fitted with electronic /mechanical disc brake systems.

What type of stem / handlebar can I install on Rave SL?

The standard bike features a 0-Bar for the road configuration and a J-Bar for the gravel version. The use of Wilier Triestina carbon spacers also makes it possible to switch to a Filante Bar and a Stemma SL.

Do the integrated cables pass through the handlebar?

The cables are integrated inside the frame, running through the superthin bearing and inside the integrated handlebar.

Is the superthin™ bearing available as a spare part?

Yes. The upper superthin bearing is not normally available on the market but is a design owned by Wilier Triestina and will only be available at the Wilier Triestina authorized dealers.

Does the Rave SL require a dedicated seatpost?

Yes, Rave SL fits an exclusive design Wilier Triestina seatpost.

How can I clean my Rave SL?

We recommend cleaning with water and a soft cloth or sponge. Please note that some cleaning agents can damage the finish on the Rave SL. We do not recommend the use of pressurized water or air when cleaning the Rave SL frame.

What frame protectors are standard?

The seat stay is protected by a dedicated rubber chainstay protector with special reinforced thickness.

What is the maximum crankset gear size that can be fitted on a Rave SL?

The maximum size of the double crankset gear is 52T for Shimano groupsets. For all other groupsets, the maximum size is 50T.



SPARE PARTS



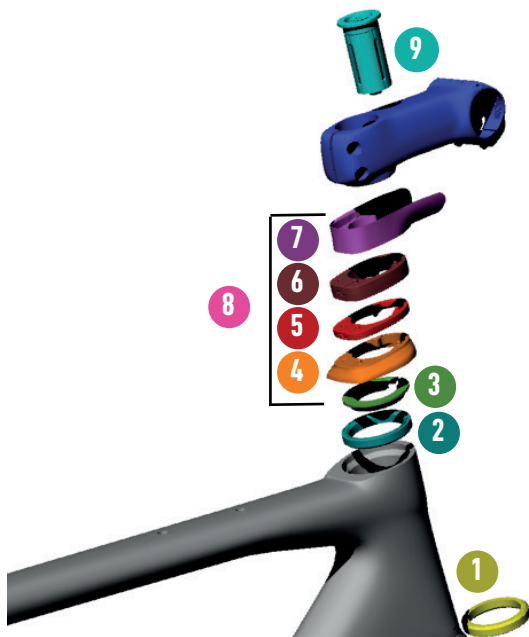

SPARE PARTS		
1	MR137	FSA BEARING 1-1/4"
2	WTP-BEARING-SSLIM	BEARING SUPERSLIM 3 9 X 46.9 X 7 SSLIM
3	WTP-2SCOMPRING	COMPOSITE COMPRESSION RING
4	W0TC	TOP COVER
5	WTP-ZSPACER5	SPACER 5MM (DX+SX)
6	WTP-ZSPACER10	SPACER 10MM (DX+SX)
7	WTP-STEMCC	RITCHEY STEM CABLE GUIDE FOR BARRA SL
8	WKITCCOL	KIT SPACERS ADLAR
9	EXROUFK	ROUND FORK EXPANDER

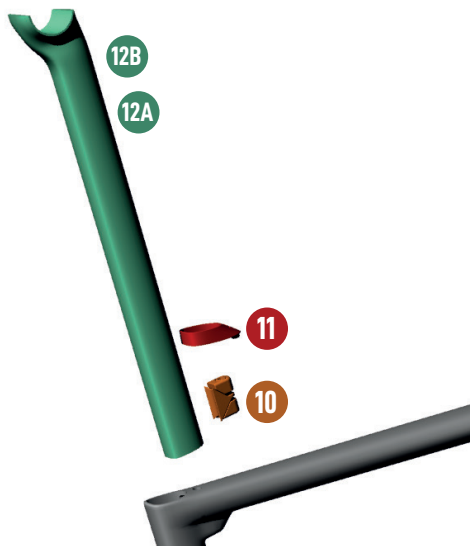

SPARE PARTS		
10	WTP-SPEXP	FILANTE SEATPOST EXPANDER
11	WTP-SPSHIELD-F	SEATPOST RUBBER SEAL FILANTE
12A	STFILA-15	SEATPOST FILANTE -15 OFFSET
12B	STFILA0	SEATPOST FILANTE ZERO OFFSET



SPARE PARTS		
13	FDCOV1X	INTERCHANGEABLE FD COVER
14	WTP-REMF	FRONT DERAILLEUR SUPPORT INTERCHANGEABLE
15	WTP-AFPROT-GR	CHAIN STAY PROTECTOR+STICKER GRAVEL
16	WORDREINF	DROPOUT REINFORCED FOR GRAVEL
17	CCN009-2	PLUG FOR INTERNAL FRAME ROUTING 4MM



