



USMAN
SLR

TECHNICAL INTRODUCTION
REV.01

USMA
SLR

2

WILIERPEDIA 2022

OFFROAD COLLECTION

USMA SLR is the new race-ready hardtail MTB that joins URTA SLR in the Wilier Triestina top-of-the-range offroad line.

Lightweight, modern, simple, and easy to manage when it comes to mechanical servicing and suspension settings, USMA SLR has been created to meet the specific needs of riders who have forever been demanding an offroad racing bike.

USMA
SLR

EXTREME LIGHTNESS

Lightness is one of the two key elements on which the design is based. We know that climbing is hard, and we know how much super-light materials can help in competition and, in general, reduce fatigue.

The USMA SLR frame weighs a mere 850 grams, an undeniably exciting platform on which to create super bikes.



SHORT TRIANGLE

To make the bike agile and responsive, we made the rear triangle very short, with a pitch of just 425 mm but with a wheel clearance that fits tires up to 2.4" (60 mm).

PROGRESSIVE GEOMETRIES

USMA SLR features modern and advanced geometries designed on a fork with 100 mm of travel.



HUS-MOD CARBON

The carbon technology used for USMA SLR is the same one featured in the high-end road range: HUS-MOD carbon, a combination of superior quality fibers with the addition of highly resistant multi-directional fiber meshes. To keep the stress generated by offroad use under control, the USMA SLR frame has been designed with special focus and care for the tube intersecting points, which have been reinforced.

Also with regard to the tubes, their exceptionally rounded forms make them the ideal solution for obtaining an excellent stiffness-to-weight ratio.



USMA
 SLR

FLOW IS FAST

There is a saying that goes "flow is fast". This is what riders will experience while riding USMA SLR. And, if we were to seek a single adjective to define USMA SLR, we would say it's balanced: lightweight and responsive uphill, fast and easy downhill.



INTEGRATED MONOCOQUE HANDLEBAR

Like its full suspended sister - URITA SLR - USMA SLR can be equipped with an integrated monocoque carbon handlebar. Using dedicated spacers, this creates a single module with the rest of the frame to increase comfort and improve the clean look of the cockpit.

Cable routing: just two holes on the head tube allow cable routing for the brake, derailleur and the dropper post, integrating them all in the frame.



ANGLES

As for the angles, the 75° seat tube allows riders to adopt the ideal position for constant pushing. Moving to the front, handlebar is tilted at 67.75°.

Combining this value with the 430 mm of reach (for a size M) and an increased BB drop, positions the USMA SLR cyclist centered on the bike, with a low center of gravity.

This configuration improves the stability in the descents, providing greater safety; both of which are necessary to take on speed when on a downslope.



USMA
SLR

COLOR	BLUE, BLACK
FINISH	MATT
COLOR CODE	U5



COLOR	BLACK, SILVER
FINISH	GLOSSY
COLOR CODE	U6



USMA
 SLR

GEOMETRIES AND SIZES

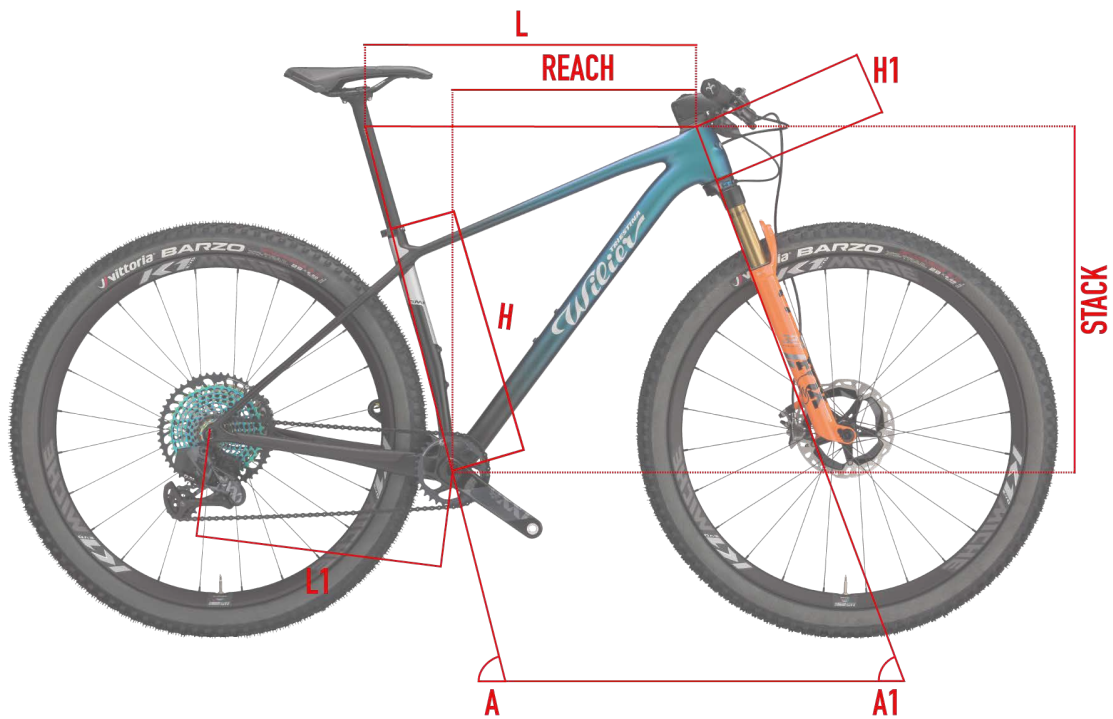

	REACH	STACK	H	L	A	H1	L1	A1	WHEELBASE
SIZE	[mm]	[mm]	[cm]	[cm]	[°]	[cm]	[cm]	[°]	[mm]
S	405	597	40	56.5	75	8.4	42.5	67.75	1090
M	430	608	44	59.3	75	9.6	42.5	67.75	1120
L	454	619	48	62.0	75	10.8	42.5	67.75	1148
XL	478	630	52	64.7	75	12.0	42.5	67.75	1177



KEYPOINTS

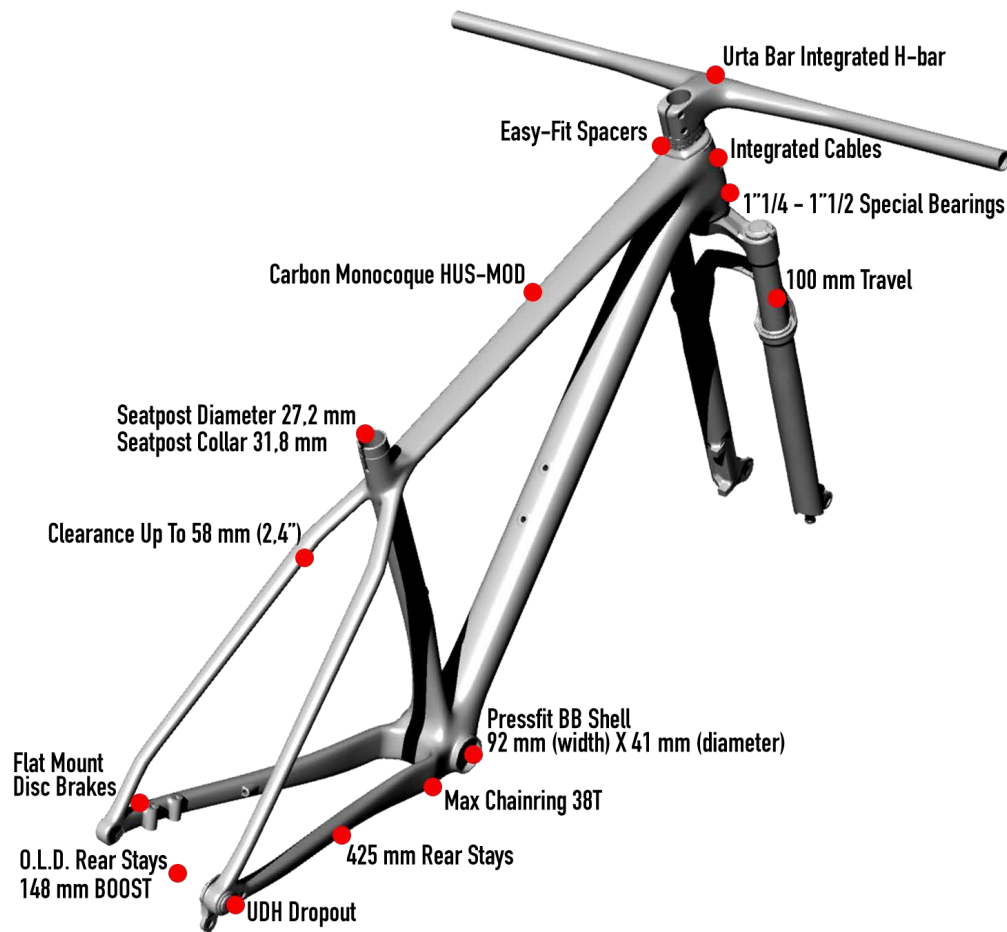

FRAME AND TECHNICAL SPECS DETAILS

HEADTUBE	1"1/4 - 1"1/2
UPPER BEARING	FSA MR137 + WTP110A-4
LOWER BEARING	FSA MR127 + HS H5068 (calotta) + HS H6088 (cono)
FRONT FORK O.L.D.	110 mm UP TO USER'S FORK
REAR STAYS O.L.D.	148 mm - BOOST GEOMETRY
BB SHELL	SHIMANO PRESS FIT (92 wide x 41 diameter) up to 38T
SEAT POST	27.2 - collar 31.8
FRONT DERAILLEUR TYPE	NA
BRAKES STANDARD	FLAT MOUNT 25mm HIGH (screw 33 length mm)



SPARE PARTS

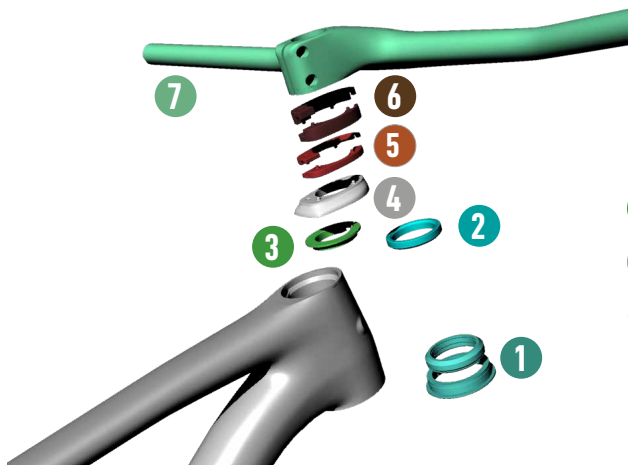

SPARE PARTS B2B CODES

1	33035336044	HEADSET LOWER PART
2	MR137	HEADSET UPPER BEARING
3	WTP110A-4	COMPRESSION RING
4	W0TC	TOP COVER
5	WTP-ZSPACER5	SPACER 5 MM
6	WTP-ZSPACER10	SPACER 10 MM
7	E1HBU	URTA BAR

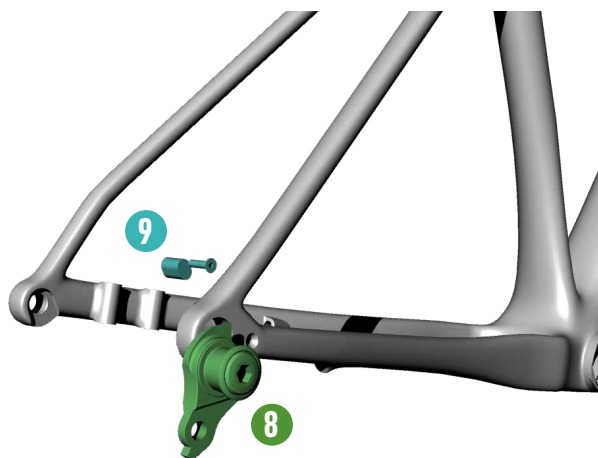

SPARE PARTS B2B CODES

8	UDH-SRAM	UNIVERSAL DER. HANGER
9	WTP-ALDROP	DROPOUT STOPPER

FAQ

How much does the frame weigh?

The frame weighs 850 grams \pm 5%, in the painted size M.

Which wheels and tires can I install?

USMA SLR can fit 29" boost wheels with tires up to 2,4" (60 mm) width.

What chainring can I install?

You can install cranksets up to 38 teeth.

Are the cables integrated in the URTA BAR?

No. The handlebar is monocoque but cables are external. The frame is compatible with easy-fit spacers.

Which handlebars can be fitted on USMA SLR?

The USMA SLR can be equipped with URTA BAR, Wilier carbon monocoque bar, or traditional handlebars.

Which groupsets can be installed on USMA SLR?

USMA SLR fits only 1x (single-crown) drivetrains, either mechanical or electronic.

How can I clean USMA SLR?

We recommend cleaning the bike with water and a soft cloth or a sponge. Please note that some cleaning agents can damage the finish on the USMA SLR. We do not recommend the use of pressurized water or air when cleaning USMA SLR frame. Such practices can damage the finish and bearings etc. Always thoroughly dry and lubricate your bicycle before storage.

Is it possible to install a dropper post on USMA SLR?

Yes, a 27.2mm dropper post can be installed with internal cable routing.

What is the optimized fork travel for USMA SLR?

The frame is designed for a 100mm travel fork.

What is the rear hanger standard used on USMA SLR?

The USMA SLR features the latest SRAM's UDH dropout.



